

Carnegie Mellon University

Higher Education



Project: Carnegie Mellon University **Location:** Pittsburgh, PA
Architect: Moore Ruble Yudell **Contractor:** PJ Dick
Partners: Specified Systems **Completion:** August 2018

Scope: Carnegie Mellon University recently opened its largest building on campus, the David A. Tepper Quadrangle, reflecting a new model of higher education that connects teaching, learning, and innovation. The 315,000-square-foot “Tepper Quad” will serve as the new home of the Tepper School of Business while intersecting with the other six Carnegie Mellon colleges and schools. Its modern design, enhanced by Sightline Commercial Solutions Track Rail, emphasizes open spaces, with an abundance of natural light and space for “planned spontaneity” to energize innovation and interconnection.

Photos courtesy of Dr. Carlos Corona www.professorcarloscorona.com



Custom-designed rolled and raked stainless steel cladding lines the building’s three curved staircases, adding a perfect finishing touch to the space.



The building’s stairs and curved overlooks feature 1/2” clear fully tempered monolithic glass, providing unobstructed views of the entire space.



Track Rail glass stair and segmented overlook railings are mechanically fastened to structural steel finished off with aluminum cover plates.



Designed for “planned spontaneity,” the vast, open lobby and dining areas allow students and faculty to easily spot each other.

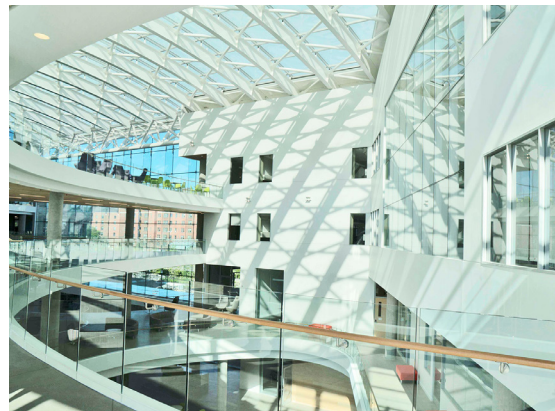

The building’s glass roof provides an abundance of natural light, while complementing the Track Rail’s glass infill installed throughout the building.



Tepper Quad’s angular staircase utilizes 3/4” glass and is strategically tucked to the side, allowing for a more spacious lobby and social areas.

We elevate places where experiences happen by providing innovative engineering, fabrication, and installation solutions to the most complex challenges. Discover our unconventional approach.